



TUMBLE DRYERS | GREEN EVOLUTION



Tumble Dryers

FD - 65 M

FD - 80 M

CONCEPT

THE PERFECT BALANCE
BETWEEN HIGH QUALITY AND
PRICE



FEATURES

- External steel casing with grey coating (skinplate), stainless steel, easy to clean finish.
- Stainless steel drum.
- Axial-radial airflow, resulting in greater drying efficiency.
- Drum with stamped perforations for the gentle treatment of fabrics.
- Lint filter at the bottom, more ergonomic, larger and improved airflow.
- Automatic reverse rotation of the drum.
- Frequency inverter for smoother operation.
- Ergonomic door with a large opening and the option of double glazing.
- Anti-wrinkle system.
- End of cycle tone.
- Emergency stop button and security micro magnet to stop operation.
- Drum motion by pulley and belt with the drum supported by wheels.
- OPL ↔ Vended
Fagor dryers can be easily converted from OPL to Self-Service and viceversa.



- **M Control** : easy and intuitive electronic control with time and temperature selection.
- "Coin ready" M control is ready for the vended laundry. Compatible with almost all payment options.



Add the optional external console or the easy display for more control of the process:

- Up 10 programs.
- Drum speed.
- Statistics.
- Technical menu.

OPTIONS:

- Optional screen to view time, temperature and program. The technical menu can also be accessed without having to use the console.



SUMMIT
SummitLaundry.com

Call 855-Summit9
Sales@SummitLaundry.com
120 Spagnoli Rd, #1B
Melville, NY 11747



TECHNICAL DATA	UNIT.	FDM - 65	FDM- 80		
CAPACITY					
Capacity 1/18	lb	70	80		
Capacity 1/20	lb	60	75		
Hourly Output *	lb/h	130.7	140.8		
Evaporation capacity *	l/h	30.9	32.1		
DRUM					
Ø Drum	in	37.25	37.25		
Ø Door	in	31.50	31.50		
Door center height	in	41	41		
Load hole bottom height	in	64.50	64.50		
Drum length	in	30.75	36.85		
Drum volume	CuFt	19	23		
POWER					
Drum motor power	hp	0.75	0.75		
Fan motor power	hp	0.75	0.75		
Electric heating power	kW	Not Available	Not Available		
Total electric power (elec.model)	kW	Not Available	Not Available		
Gas heating power	btu/h	140,000	140,000		
Total electric power (gas model)	kW	1.15	1.15		
Steam heating power	kW	50.1	50.1		
Steam heating power (gas model)	kW	1.15	1.15		
CONNECTIONS		ELECTRICAL	STEAM / GAS	ELECTRICAL	STEAM / GAS
120 V / 60 Hz / 1	FLA	-	30 A	-	30 A
208-240 V / 50-60 Hz / 1	FLA	Not Available	-	Not Available	-
208-240 V / 50-60 Hz / 3	FLA	Not Available	-	Not Available	-
Ø Gas inlet	BSP	1/2"		1/2"	
Ø Steam inlet	BSP	1"		1"	
Ø Condensed (Steam models)	BSP	1"		1"	
DIMENSIONS / PACKING DIMENSIONS					
Net Width / Gross Width	in	38.75 / 42	38.75 / 42		
Net Depth / Gross Depth	in	41.50 / 45.50	47.60 / 51.60		
Net Height / Gross Height	in	76.60 / 82	76.60 / 82		
Height without heating battery	in	-	-		
Net weight / Gross weight	lb	507 / 573	573 / 628		
OTHERS					
Max airflow	CFM	706	706		
Ø Duct Size	in	8	8		
Sound level	dB	65	65		

* It may vary depending on the type of heating, filter cleanliness or extraction type.

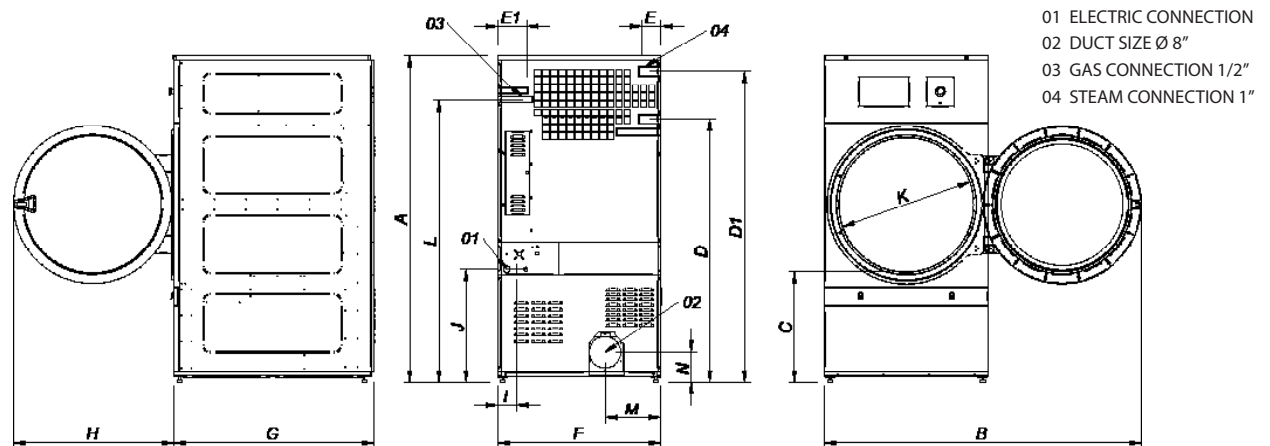

	A	B	C	D	D1	E	E1	F	G	H	I	J	K	L	M	N
FDM-65	76.60	75	25	62.60	74	4.50	6.85	38.75	41.50	37.75	4.30	26.75	31.60	67.25	13.35	7
FDM-80	76.60	75	25	62.60	74	4.50	6.85	38.75	47.60	37.75	4.30	26.75	31.60	67.25	13.35	7

