



TUMBLE DRYERS | GREEN EVOLUTION



Tumble Dryers

FD - 65 TP2

FD - 80 TP2

ADVANCE

HIGH PERFORMANCE, EFFICIENT
TECNOLOGY, ADVANCE DRYING



873FGD7E

- User friendly and totally programmable microprocessor with a 7" **Touch II screen**
- USB Connection to upload programming or download traceability, data analysis. You can program time of the day promotions and discounts automatically.
- Videos shown on display: ads, instructions (useful for coin laundry)

- Anti-wrinkle system.
- End of cycle tone.
- Emergency stop button and security micro magnet to stop operation.
- Drum motion by pulley and belts with the drum supported by wheels.
- Automatic reverse rotation of the drum.
- Frequency inverter for smoother operation.

ŽA B> ↔ HW VVV 8SYadVdVtEUS` TWW6[k
Ua` hVfVW Xb_ AB>fa EWZEvh[UWS` V hLW
hVtSZ

- Easy-to-clean, outer casing in gray skin-plate with stainless steel look.
- Ergonomic big loading door with a 180° opening and the option of double glazing.
- Stainless steel drum.
- Axial-radial airflow, resulting in greater drying efficiency.
- Drum with special smooth perforations for the gentle treatment of fabrics.
- Stainless steel lint filter at the bottom for more ergonomic, larger, and improved airflow.

OPTIONS:

- iDry System (Intelligent moisture sensor)
- FK System (Integrated fire prevention system).
- Double door-glass.
- Stainless steel side panels.
- Stainless steel front panel.



SUMMIT
SummitLaundry.com

Call 855-Summit9
Sales@SummitLaundry.com
120 Spagnoli Rd, #1B
Melville, NY 11747



TECHNICAL DATA	UNIT.	FD- 65	FD- 80		
CAPACITY					
Capacity 1/18	lb	70	80		
Capacity 1/20	lb	60	75		
Hourly Output *	lb/h	130.7	140.8		
Evaporation capacity *	l/h	30.9	32.1		
DRUM					
Ø Drum	in	37.25	37.25		
Ø Door	in	31.50	31.50		
Door center height	in	41	41		
Door bottom height	in	64.50	64.50		
Drum depth	in	30.75	36.85		
Drum volume	cu ft	19.4	23.3		
POWER					
Drum motor power	hp	0.75	0.75		
Fan motor power	hp	0.75	0.75		
Electric heating power (elec.model)	kW	Not Available	Not Available		
Total electric power (elec.model)	kW	Not Available	Not Available		
Gas heating power	btu/h	140,000	140,000		
Total electric power (gas model)	kW	1.15	1.15		
Steam heating power	kW	50.1	50.1		
Steam heating power (gas model)	kW	1.15	1.15		
CONNECTIONS		ELECTRIC.	GAS	ELECTRIC.	GAS
120 V / 60 Hz / 1	FLA	-	30 A	-	30 A
208-240 V / 50-60 Hz / 1	FLA	Not Available	-	Not Available	-
208-240 V / 50-60 Hz / 3	FLA	Not Available	-	Not Available	-
Gas connection	BSP	-	1/2"	-	1/2"
DIMENSIONS / PACKING DIMENSIONS					
Net Width / Gross Width	in	38.75 / 42		38.75 / 42	
Net Depth / Gross Depth	in	41.50 / 45.50		47.60 / 51.60	
Net Height / Gross Height	in	76.60 / 82		76.60 / 82	
Height without heating battery	in	-		-	
Net weight / Gross weight	lb	507 / 573		573 / 628	
OTHERS					
Max airflow	CFM	706		706	
Ø Duct Size	in	8		8	
Sound level	dB	65		65	

* It may vary depending on the type of heating, filter cleanliness or extraction type.

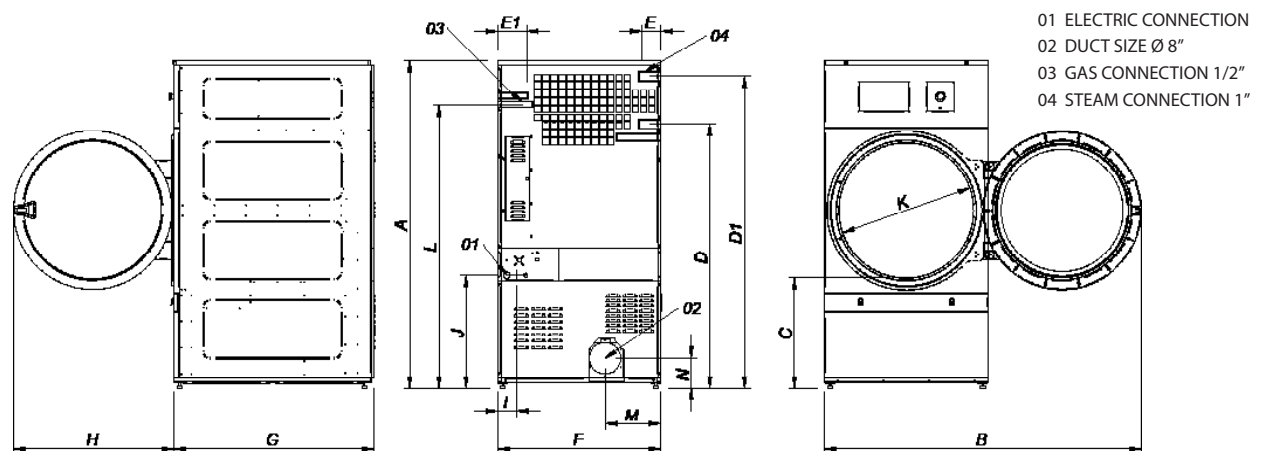

DIMENSIONS (in)	A	B	C	D	D1	E	E1	F	G	H	I	J	K	L	M	N
FD-65	76.60	75	25	62.60	74	4.50	6.85	38.75	41.50	37.75	4.30	26.75	31.60	67.25	13.35	7
FD-80	76.60	75	25	62.60	74	4.50	6.85	38.75	47.60	37.75	4.30	26.75	31.60	67.25	13.35	7

